

PT15-12

12Volt 15Ah

Specifications

Nominal Voltage(V) 12V

Nominal Capacity

| | | |
|--------------|--------------------|---------|
| 20 hour rate | (0.25A to 10.50V) | 15Ah |
| 10 hour rate | (0.475A to 10.50V) | 13.76Ah |
| 5 hour rate | (0.85A to 10.20V) | 12.71Ah |
| 1 C | (5A to 9.60V) | 13.09Ah |
| 3 C | (15A to 9.60V) | 15.7Ah |

Weight Approx. 4.3kg(9.48Lbs.)

Internal Resistance (at 1KHz) Approx. 14mΩ

Maximum Discharge Current for

5 seconds: 75A

Charging Methods at 25°C (77°F)

Cycle use:

Charging Voltage 14.4 to 15.0V

Coefficient -5.0mV/°C/cell

Maximum Charging Current : 4.5A

Standby use:

Float Charging Voltage 13.5 to 13.8V

Coefficient -3.0mV/°C/cell

Operating Temperature Range

Charge -15°C (5°F) to 40°C (104°F)

Discharge -15°C (5°F) to 50°C (122°F)

Storage -15°C (5°F) to 40°C (104°F)

Charge Retention (shelf life) at 20°C (68°F)

| | |
|---------|-----|
| 1 month | 92% |
| 3 month | 90% |
| 6 month | 80% |

Case Material ABS UL94 HB

Option: Flammability resistance of (UL94 V-0)

Terminal F4



Dimensions

mm(inch)

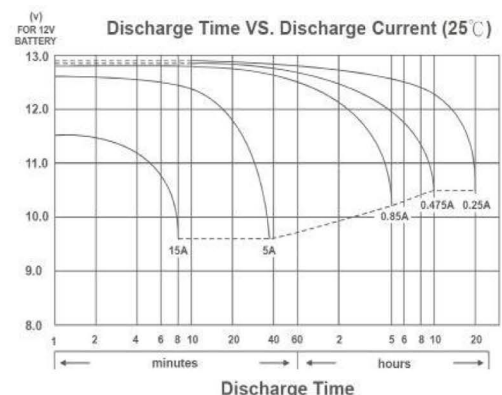
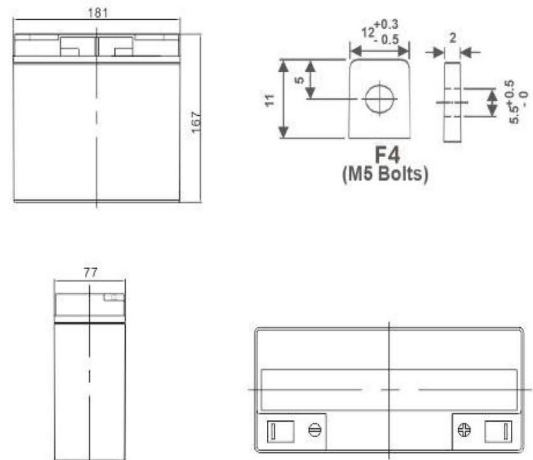

Effect of Temperature on Capacity 25°C(77 F)

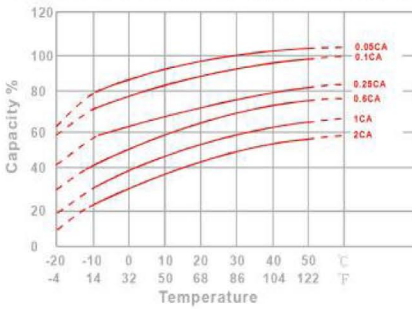

Capacity Retention Characteristic

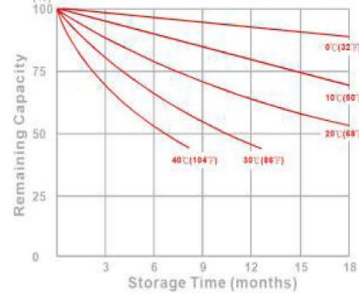

Trickle (or float) Service Life

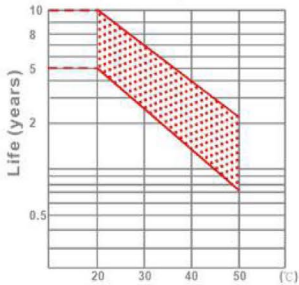

Cycle Service Life

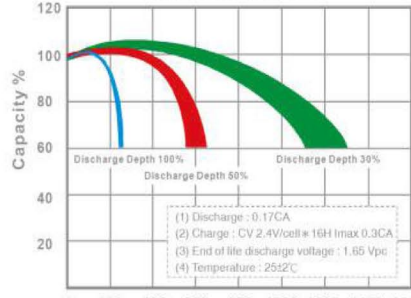

Constant Current Discharge Characteristics : A (25°C)

| F.V/Time | 5MIN | 10MIN | 15MIN | 30MIN | 1HR | 2HR | 3HR | 4HR | 5HR | 8HR | 10HR | 20HR |
|----------|-------|-------|-------|-------|-------|------|------|------|------|------|------|------|
| 1.60V | 69.22 | 45.61 | 33.99 | 19.67 | 11.40 | 6.73 | 4.89 | 3.89 | 3.29 | 2.20 | 1.79 | 0.93 |
| 1.65V | 66.72 | 44.25 | 33.10 | 19.24 | 11.19 | 6.63 | 4.83 | 3.85 | 3.25 | 2.17 | 1.77 | 0.92 |
| 1.70V | 63.47 | 42.47 | 31.93 | 18.67 | 10.91 | 6.50 | 4.74 | 3.78 | 3.20 | 2.14 | 1.75 | 0.91 |
| 1.75V | 59.29 | 40.16 | 30.41 | 17.92 | 10.54 | 6.32 | 4.62 | 3.70 | 3.13 | 2.11 | 1.72 | 0.90 |
| 1.80V | 54.02 | 37.22 | 28.45 | 16.95 | 10.06 | 6.10 | 4.47 | 3.58 | 3.04 | 2.05 | 1.68 | 0.88 |
| 1.85V | 47.54 | 33.53 | 25.97 | 15.72 | 9.44 | 5.80 | 4.27 | 3.44 | 2.93 | 1.98 | 1.63 | 0.86 |

Constant Power Discharge Characteristics : WPC (25°C)

| F.V/Time | 5MIN | 10MIN | 15MIN | 30MIN | 1HR | 2HR | 3HR | 4HR | 5HR | 8HR | 10HR | 20HR |
|----------|-------|-------|-------|-------|-------|-------|------|------|------|------|------|------|
| 1.60V | 119.2 | 78.70 | 60.32 | 36.27 | 21.64 | 12.94 | 9.48 | 7.59 | 6.43 | 4.35 | 3.57 | 1.86 |
| 1.65V | 117.9 | 78.37 | 59.97 | 36.00 | 21.46 | 12.84 | 9.41 | 7.53 | 6.39 | 4.32 | 3.54 | 1.85 |
| 1.70V | 113.4 | 76.06 | 58.36 | 35.13 | 21.00 | 12.63 | 9.27 | 7.42 | 6.30 | 4.27 | 3.50 | 1.83 |
| 1.75V | 107.8 | 73.22 | 56.38 | 34.07 | 20.39 | 12.35 | 9.08 | 7.28 | 6.19 | 4.20 | 3.44 | 1.81 |
| 1.80V | 99.97 | 69.03 | 53.49 | 32.55 | 19.56 | 11.97 | 8.82 | 7.09 | 6.04 | 4.11 | 3.37 | 1.77 |
| 1.85V | 89.54 | 63.30 | 49.53 | 30.48 | 18.48 | 11.45 | 8.47 | 6.82 | 5.83 | 3.98 | 3.27 | 1.73 |

(Note) The above characteristics data are average values obtained within three charge/discharge cycle not the minimum values.